

## DETALLES CONSTRUCTIVOS 3D

- MALLA PERIMETRAL
- COLUMNAS
- PUERTA DE GARAJE

Carlos Pinto Calderón  
Francisco Jose Loza T.

•La Paz Bolivia Ene/2010



# Detalle de armadura de columna para puerta de garaje Columna de 0.20 x 0.20 y zapata de 0.60 x 0.60

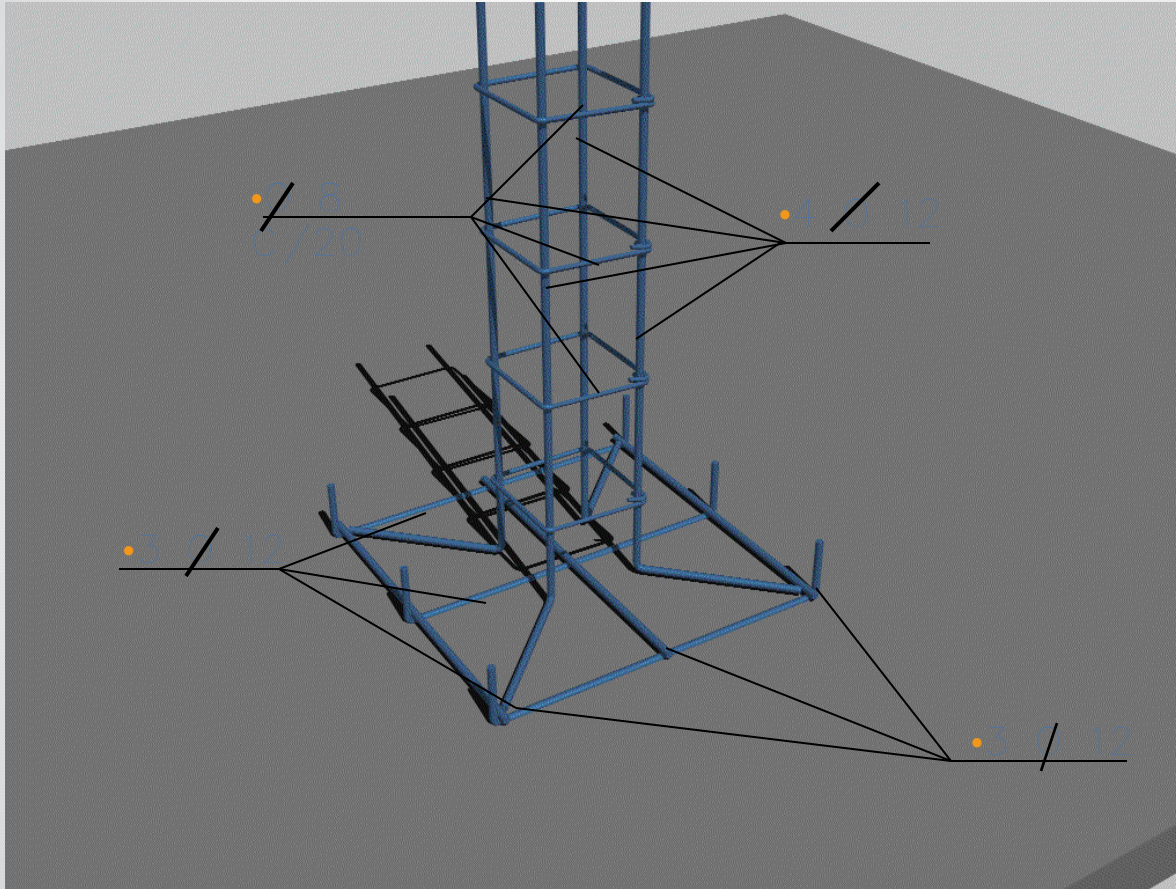

## Vista de zapata y columna

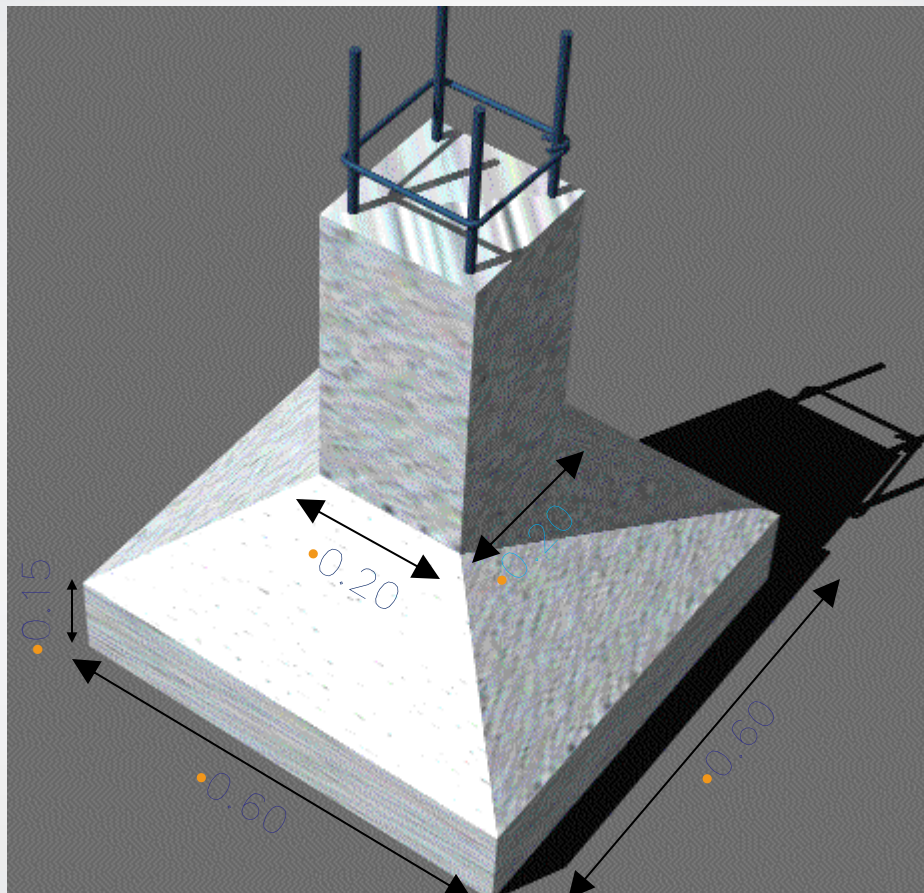

## Vista de soporte de malla en los extremos

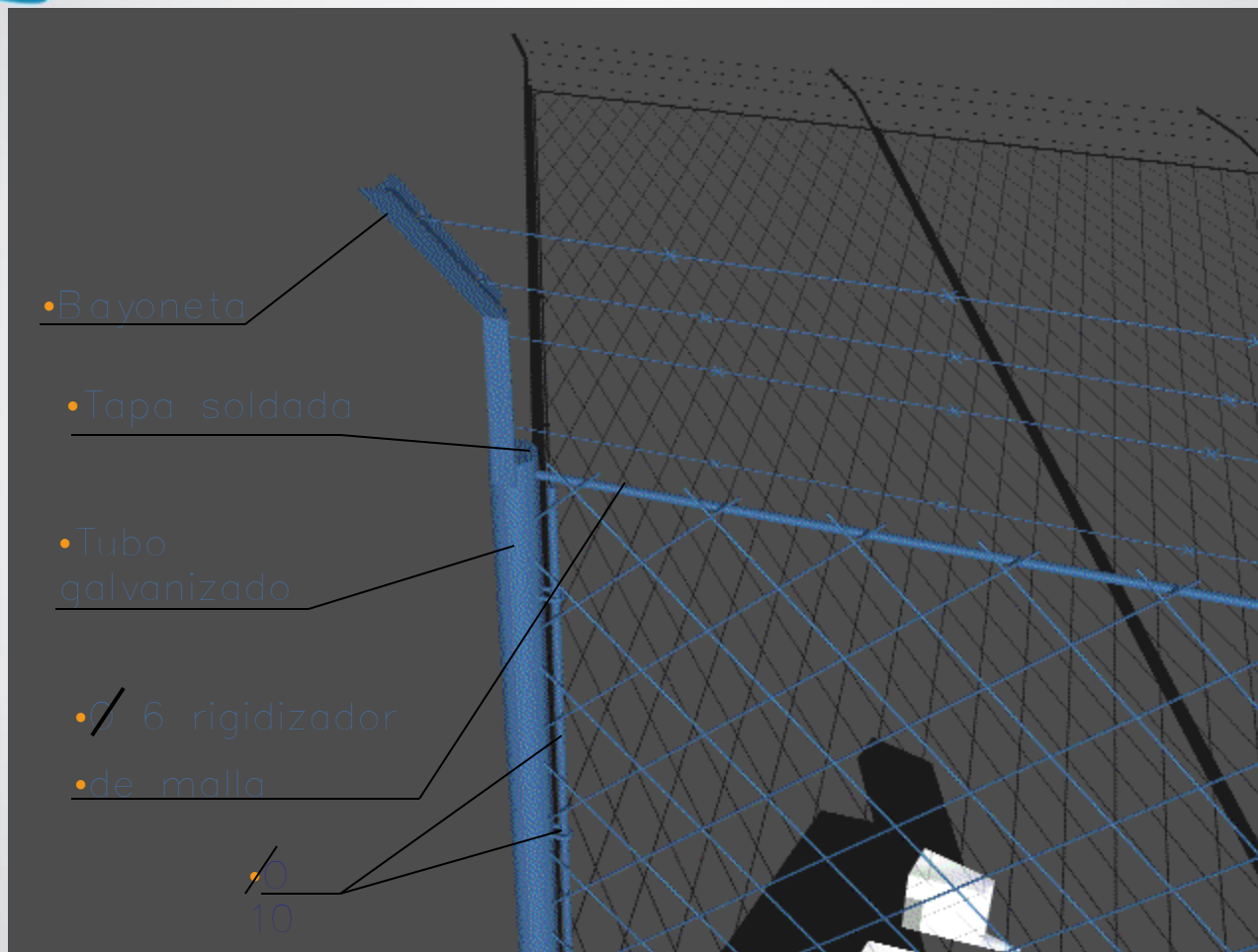

## Soporte de malla en los tramos intermedios

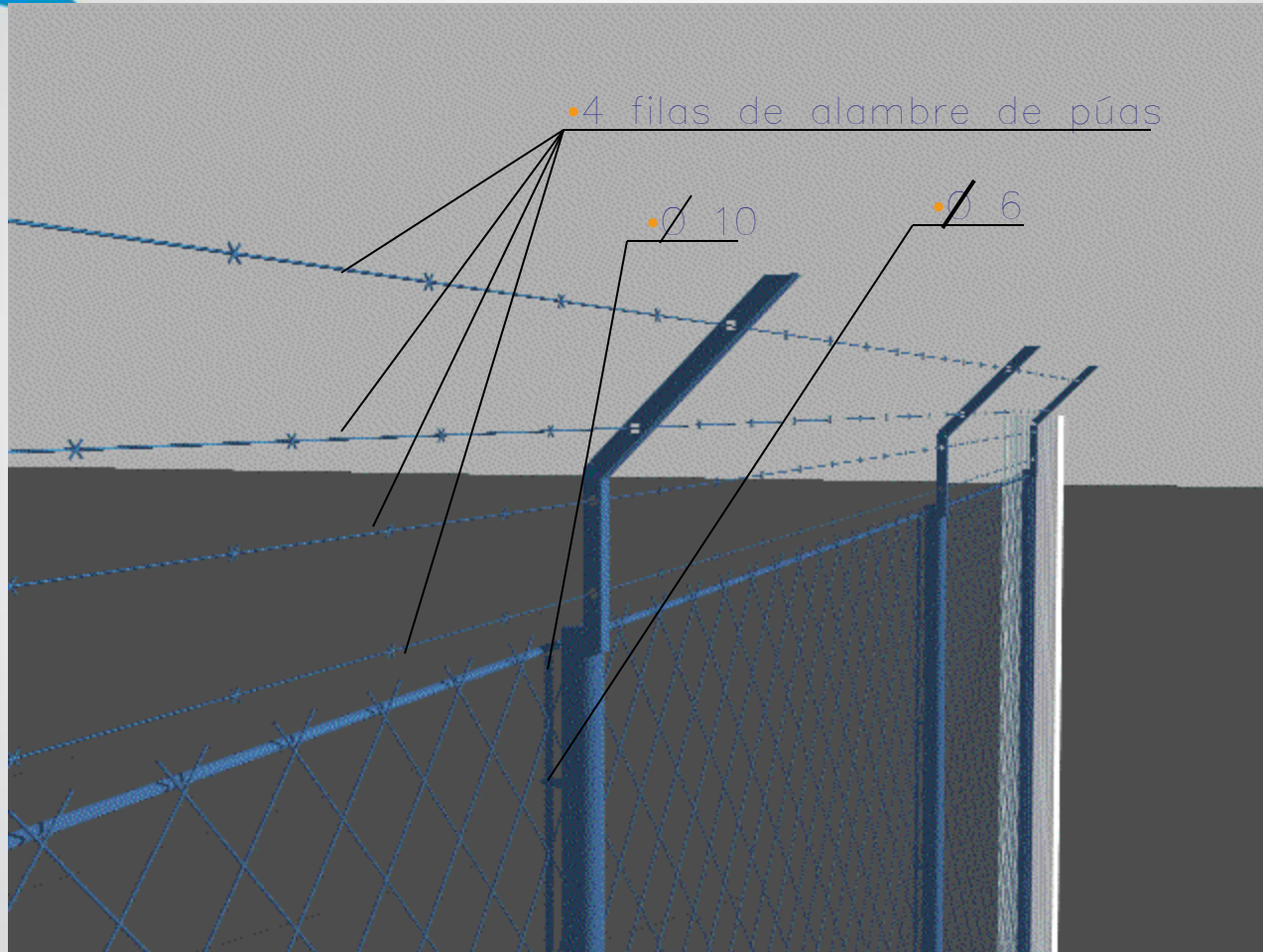



## Detalle de soporte de malla

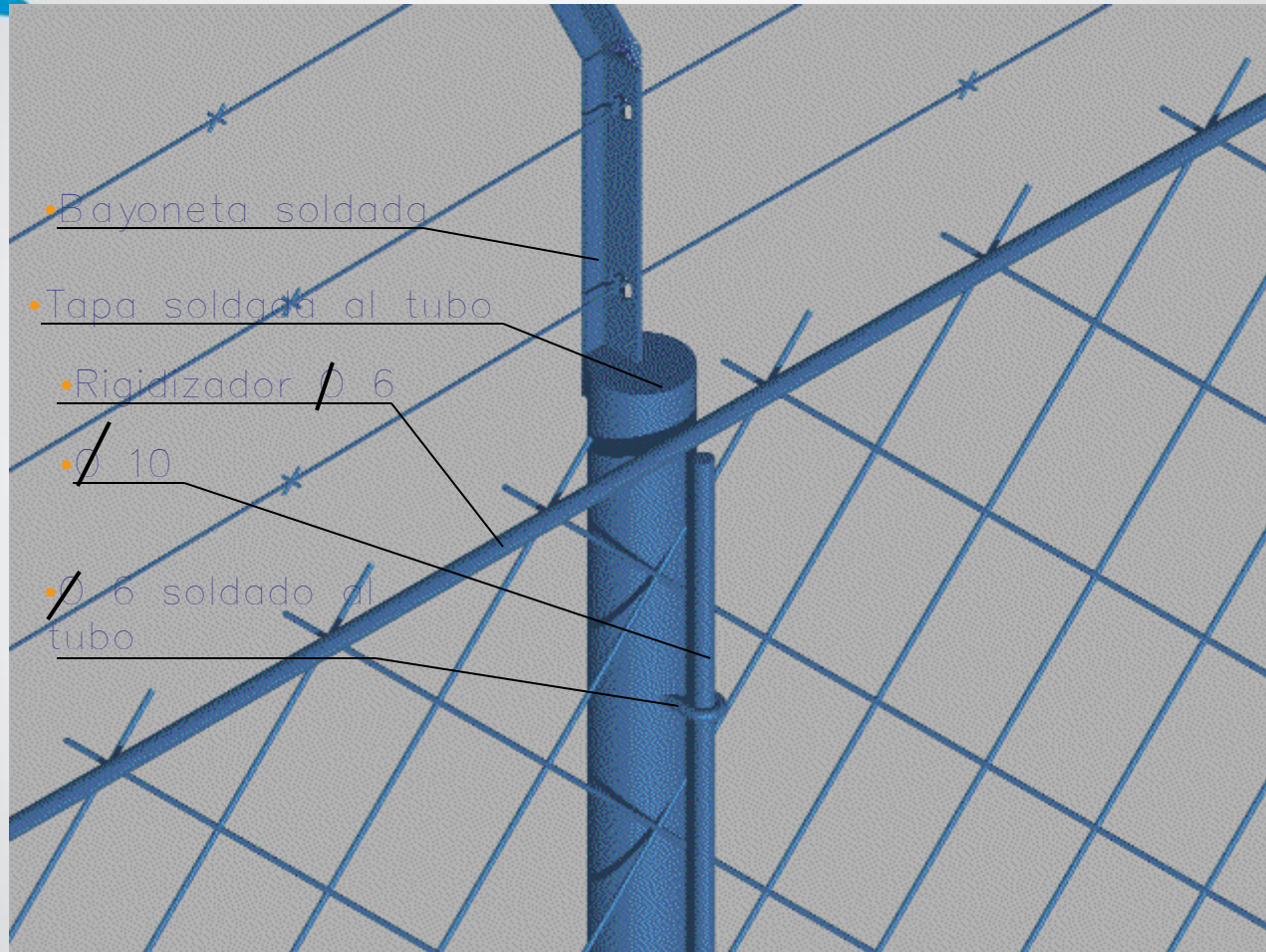

## Vista frontal de malla



- Malla empotrada
- al sobrecimiento

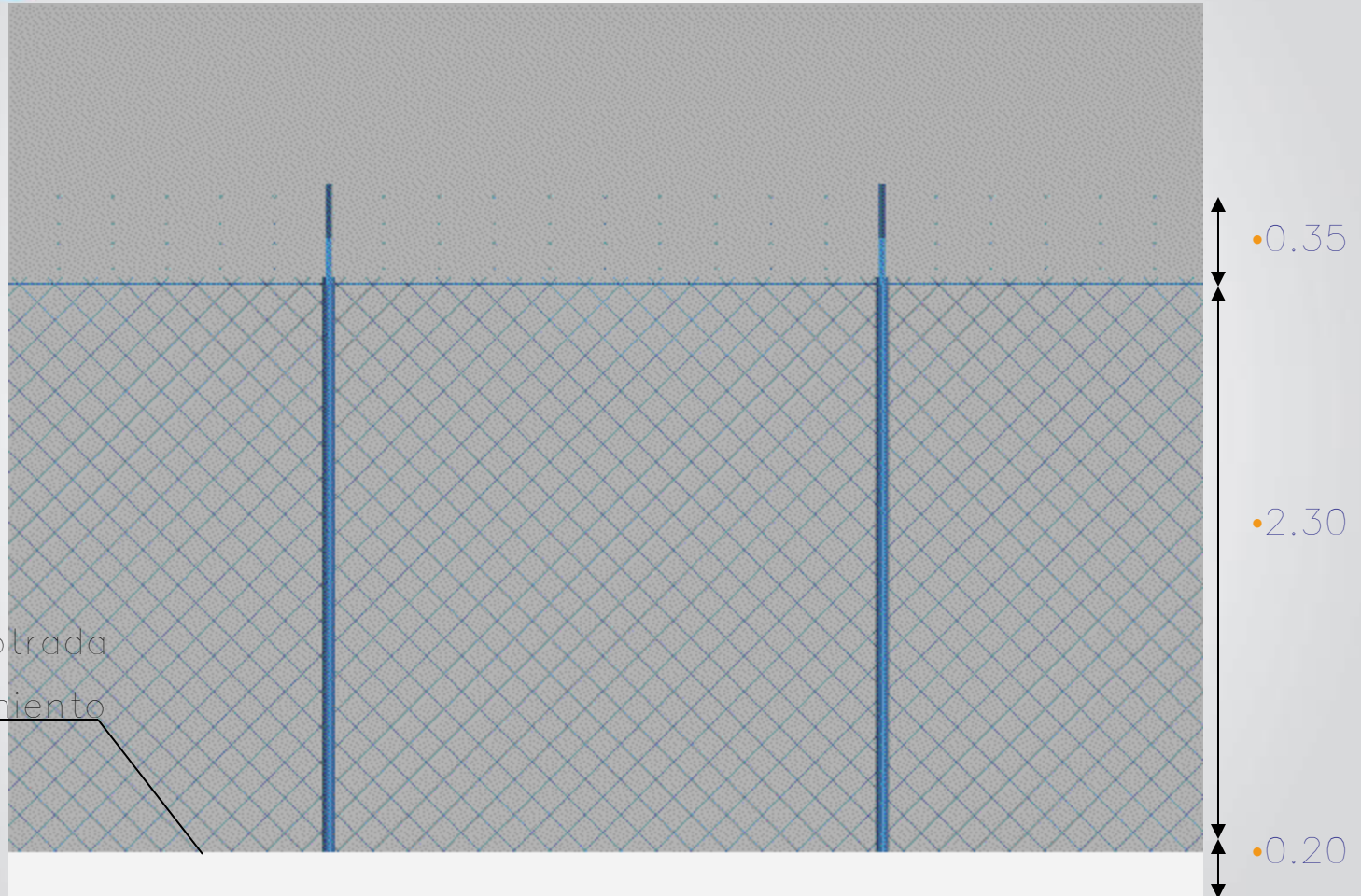



## Vista frontal de puerta de garaje

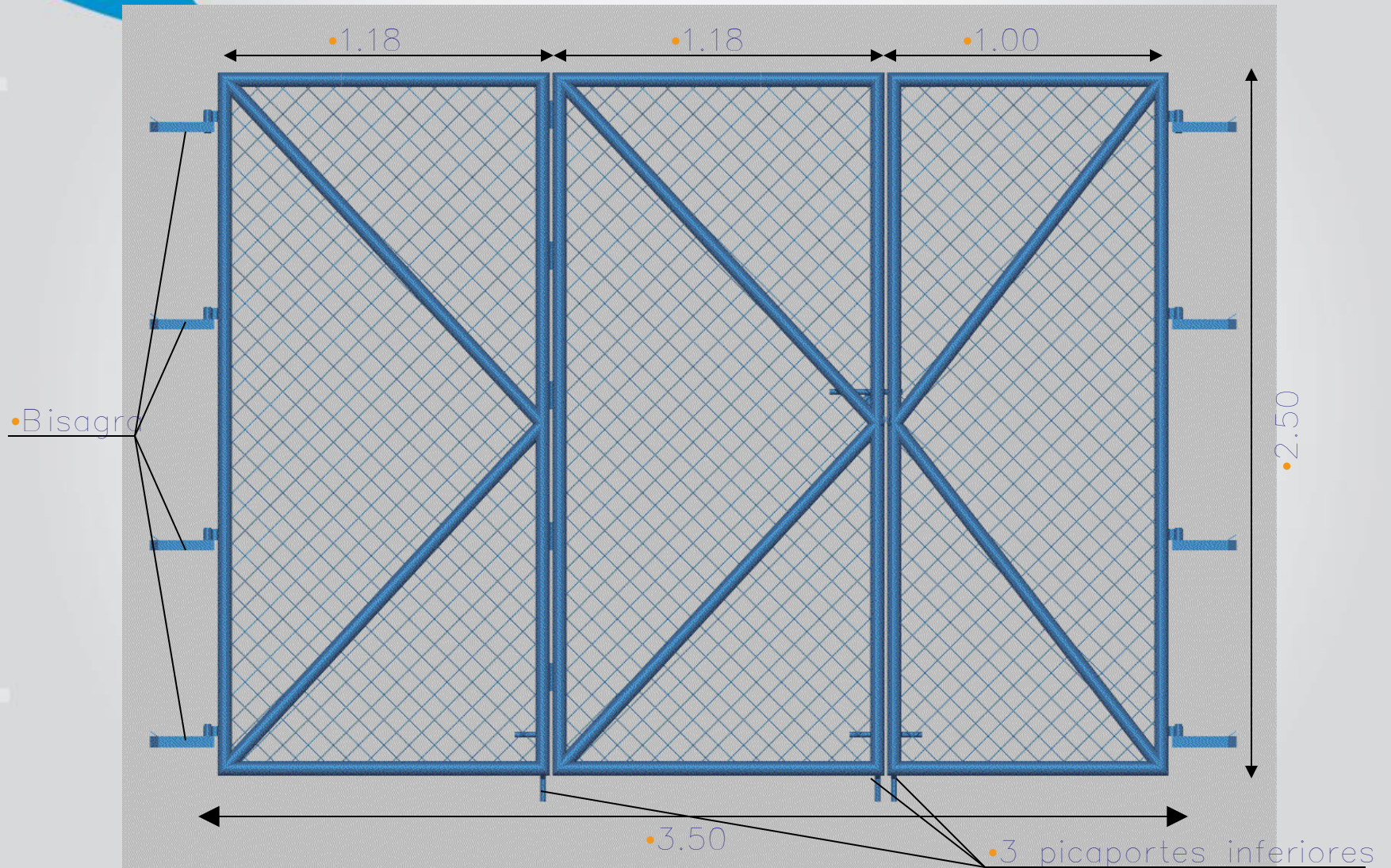



## Vista posterior de puerta de garaje



•Tubo galvanizado de 2 pulgadas x 4mm

•Picaporte

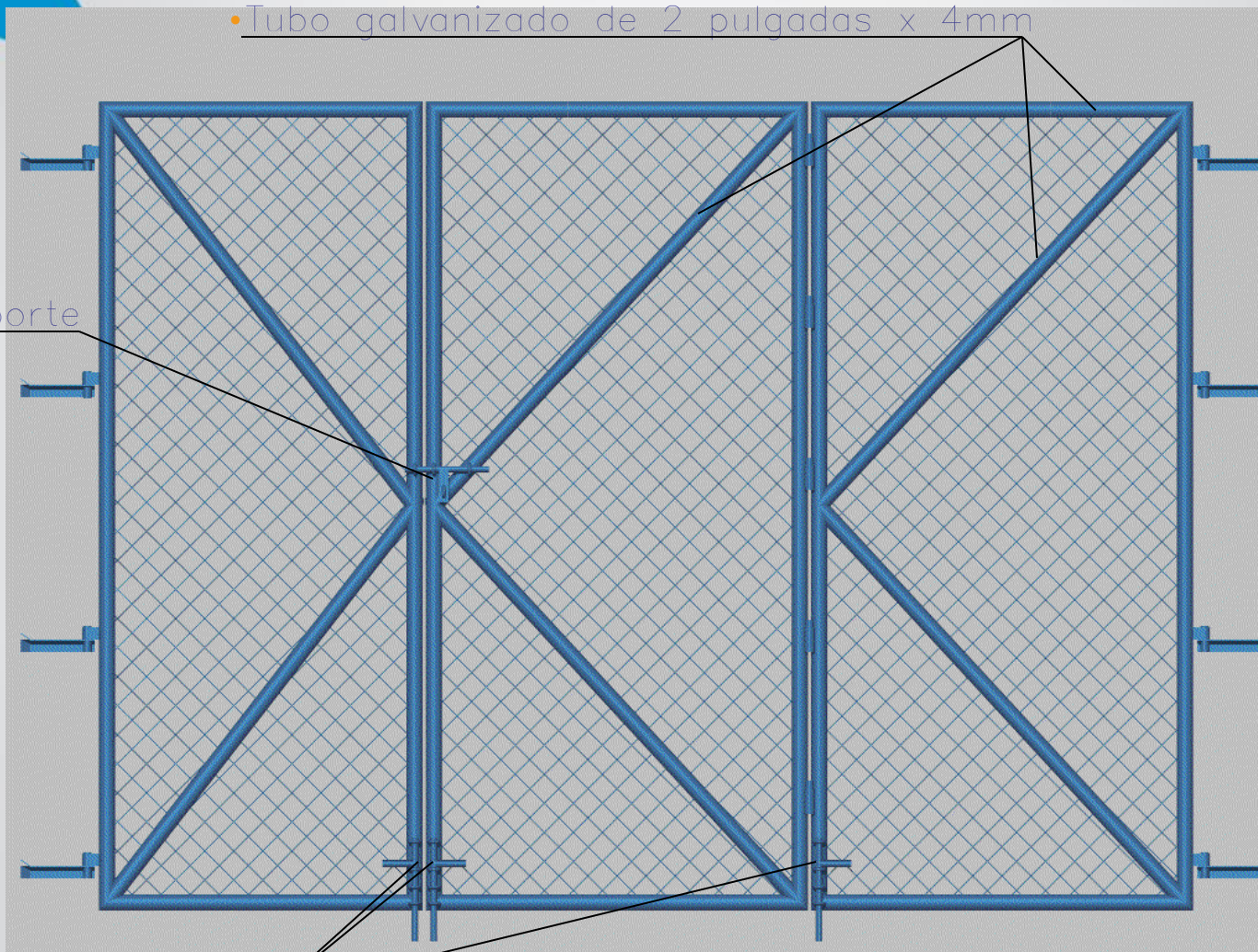

•Picaporte

## Detalle de bisagra y anclaje

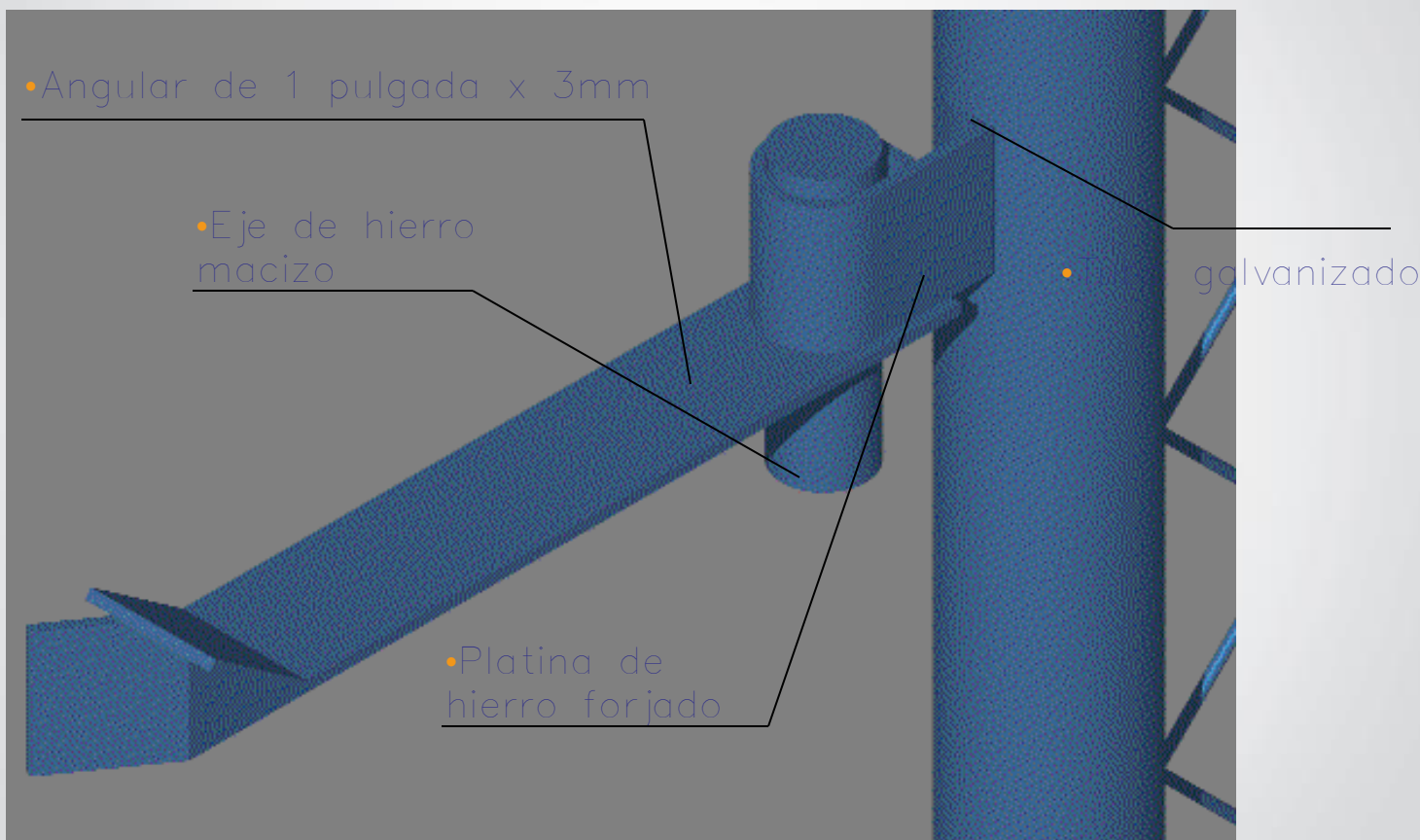

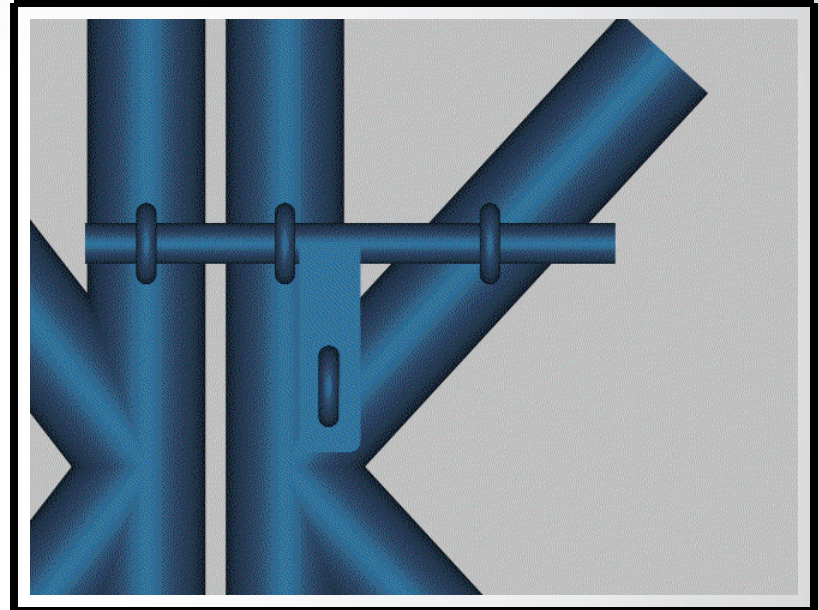
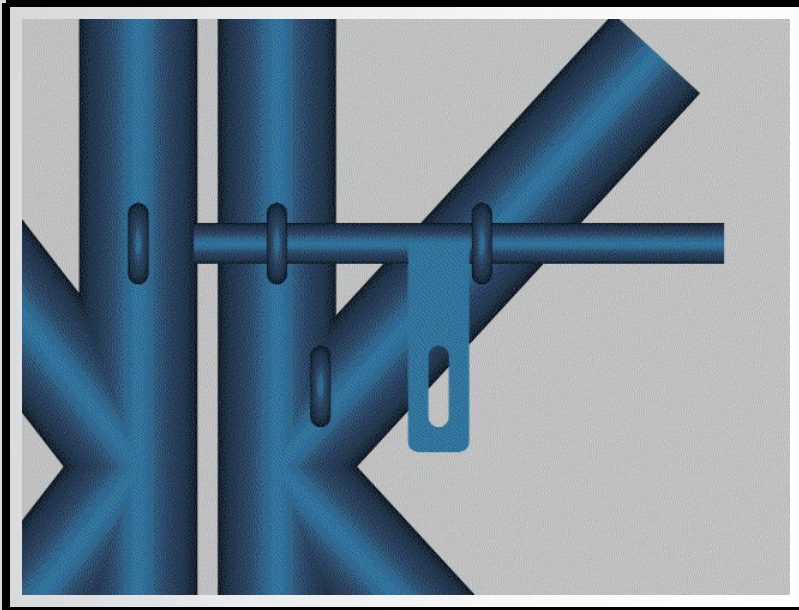



## Detalle picaporte

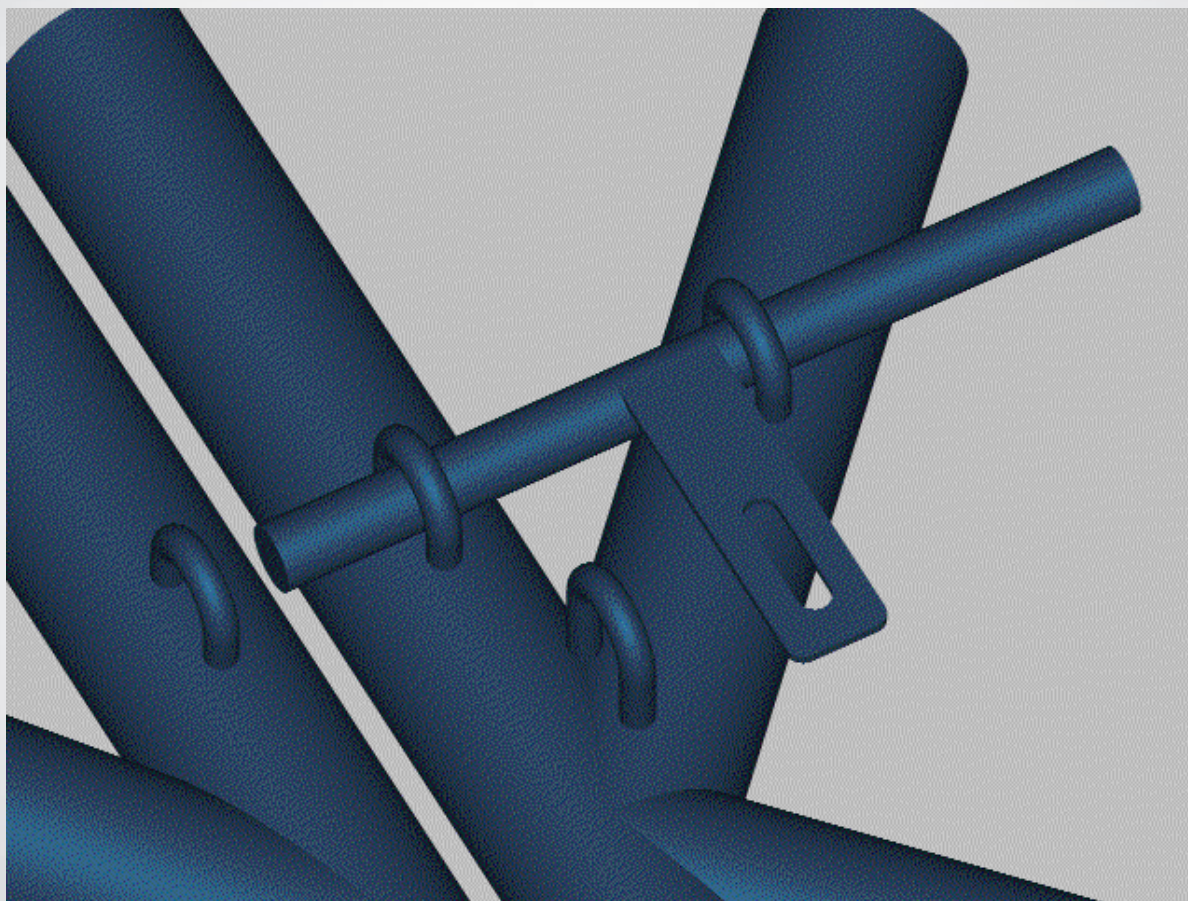



# Detalle de picaporte inferior

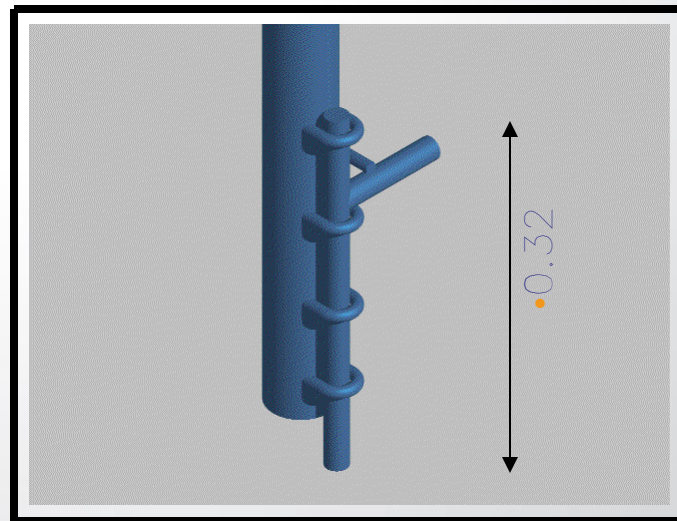
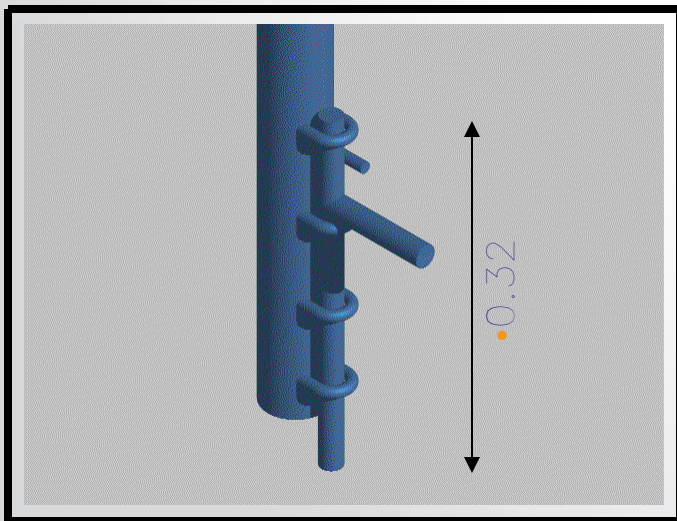
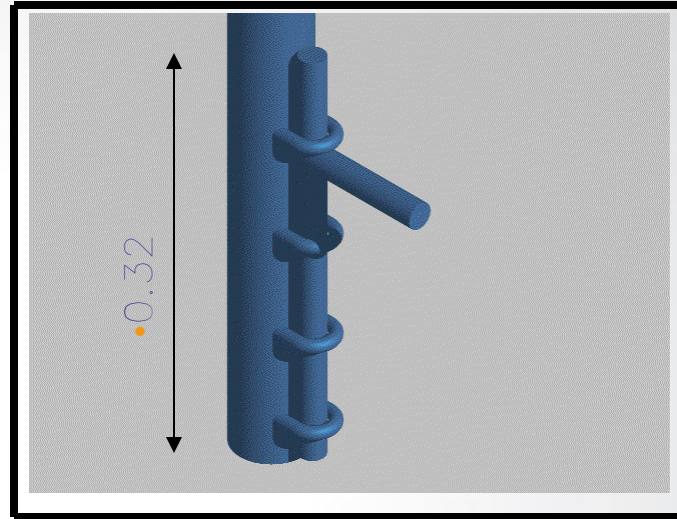
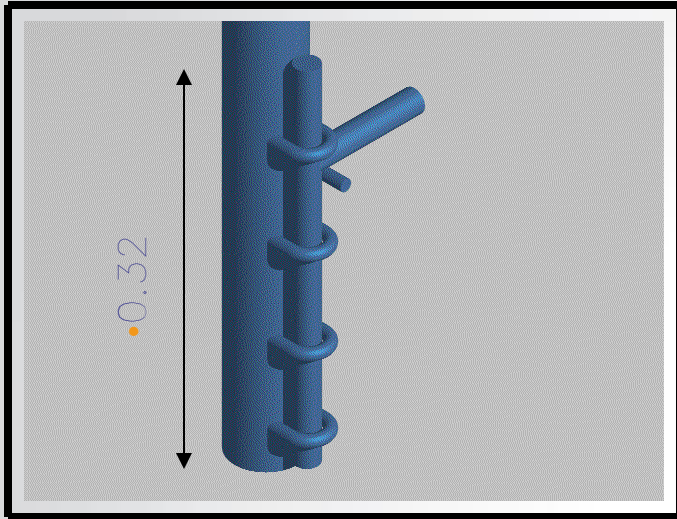

## Ganchos exteriores para candado

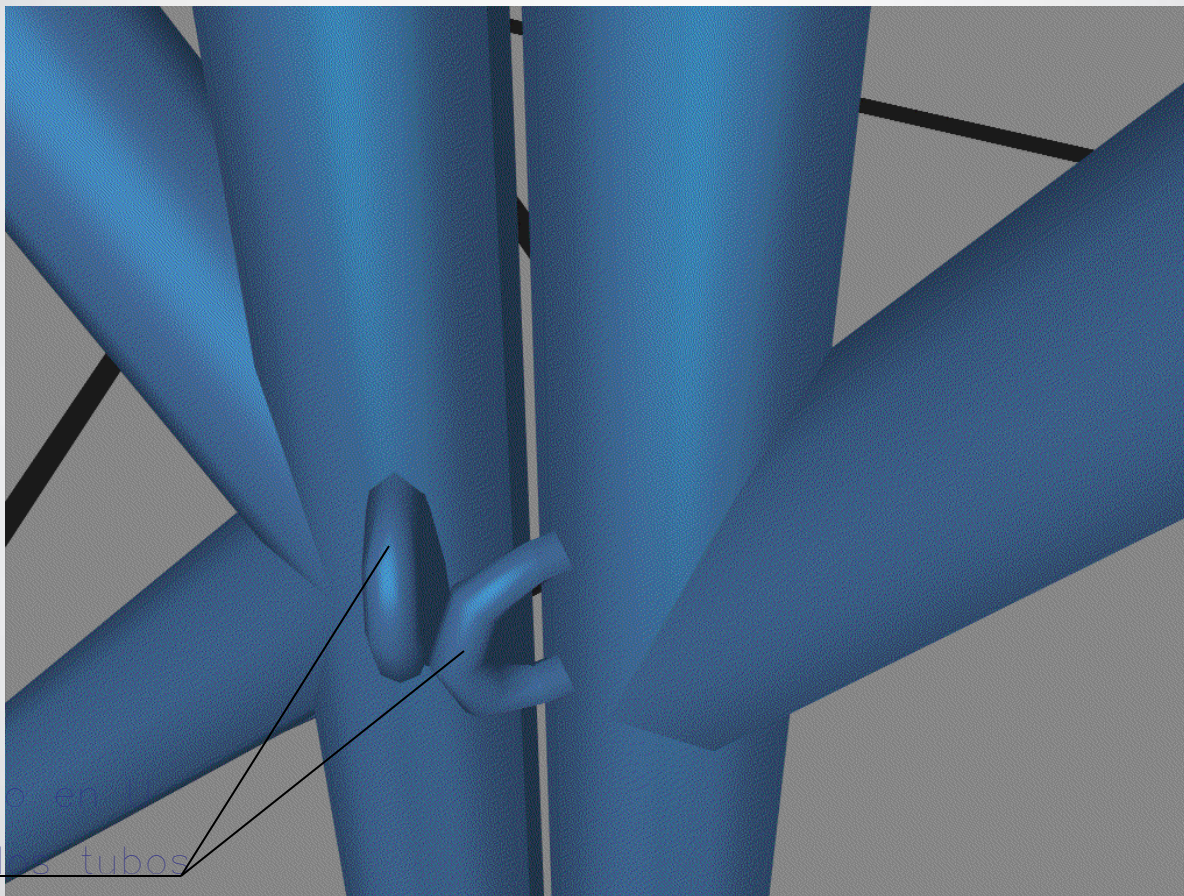

- 6 doblado en U
- soldado a los tubos